

YAMATO

INDUSTRIAL SEWING MACHINE

ILLUSTRATED SPARE PARTS LIST

FOR

MODEL DCS CLASS

MODEL DCS-301

DCS-303

DCS-305

DCS-321

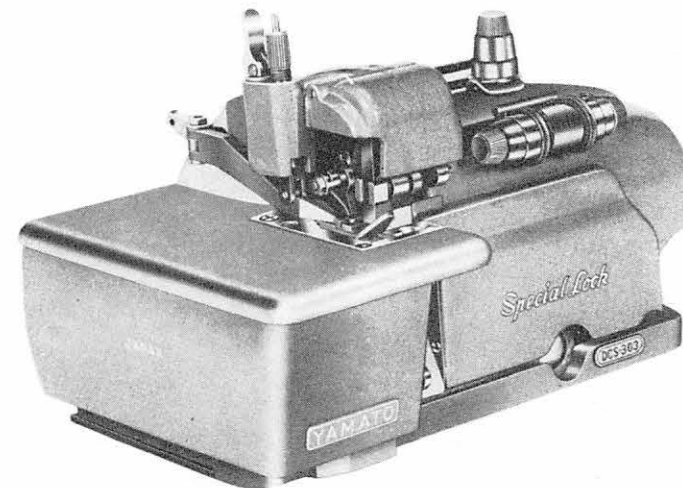

KONDO SEWING MACHINE CO., LTD.

INDEX

Plate No.	Parts No.	Plate No.	Parts No.	Plate No.	Parts No.	Plate No.	Parts No.	Plate No.	Parts No.	Plate No.	Parts No.	Plate No.	Parts No.	Plate No.	Parts No.
1,9	44	8	3631	7	6841	3	30156	7	30274	5	30415	9	30678	4	31245
8	247	7	3632	10	6861	3	30157	7	30275	5	30416	9	30679	6	31315
9	335	7	3635	13	6903	3	30162	7	30276	5,13	30421	9	30680	11	31317
4	341	2	4312	13	6904	3	30163	7	30277	5	30422	9	30681	5	31422
10	419	12	4326	2	7609	3	30164	7	30278	5	30424	9	30682	8	31531
10	509	6,12	4351	3,4	7616	2	30167	7	30280	5	30425	9	30683	11	31533
2	517	2	4352	4,5,6,9	7650	3	30168	7	30283	7	30431	9	30684	10	31590
8	551	5	4353	1	7678	3	30170	4	30291	7	30432	9	30686	11	31591
3	566	2	4356	3	9127	3	30171	6	30305	5	30433	9	30687	12	31592
1	578	5,6,8	4431	8	9209	2	30173	6	30306	7	30501	2	30688	12	31593
2	728	4,5,6,8	4432	8	9503	2	30174	6	30307	8	30510	9	30689	12	31594
2	01111	3,5	4434	4,5	9604	3	30182	6	30308	8	30511	9	30690	12	31597
2,3,10	1156	9	4435	10	9909	1	30185	6	30309	8	30512	10	30691	12	31598
6	1174	3	4438	3,9	9932	7	30205	6	30310	8	30513	10	30692	12	31599
1,2,6	1196	2	4441	2	30112	7	30214	6	30311	8	30514	10	30693	12	31600
2,8,12	1202	5	4591	2	30114	7	30215	6	30312	8	30515	7	30701	12	31601
10	1208	5	4631	2	30115	4	30220	6	30313	8	30516	10	30711	10	31612
1	1216	5	4632	2	30121	4,5	30223	6	30315	8	30517	10	30716	11	31613
5,10	1222	5	5031	2	30123	4	30224	12	30318	4	30521	10	30720	11	31614
12	1229	10,11,12	5036	2	30124	4	30225	2	30321	4	30522	1	30742	10	31621
10	1332	7	5040	2	30126	4,8,	30226	2	30322	10	30531	10	30743	10	31622
2	1333	2,4	5041	2	30127	4	30227	1	30323	8,10	30532	10	30745	13	32550
13	1398	3	5043	2	30128	4,8,	30228	1	30324	7	30542	10	30746	2	37106
7	1419	2	5051	2	30131	4	30229	6	30325	7	30543	10	30748	5,13	37514
4	1435	2	5131	2	30133	4	30230	2	30326	8	30544	10	30750	2	37635
10	1448	3	5341	2	30134	4	30231	6	30327	8	30547	10	30751	10	37675
1,4,7,9	1457	4,12	5342	2	30135	4	30232	6	30330	8	30548	1	30753	13	37901
2,10	1459	7	5431	2	30136	10	30241	7	30331	8	30549	1	30754	13	37902
5	1613	2	6040	2	30137	4	30242	6	30332	8	30550	10	30755	13	37903
4,12	1732	8	6041	2	30139	5	30245	6	30338	10	30618	10	30756	13	37909
2	1893	4	6141	2	30141	1	30251	6	30339	10	30660	10	30771	13	37911
7	2043	4	6142	2	30142	2	30252	5	30404	10	30661	11	31231	13	37912
1	2133	1	6241	2	30143	2	30254	5	30405	9	30662	11	31232	13	37913
6	2237	9	6244	3	30145	2	30255	5,8	30406	9	30663	11	31233	13	37917
8	2242	9	6249	3	30146	1	30256	5	30407	9	30664	11	31235	13	37918
6,9	3432	9	6437	3	30147	4	30258	5	30408	9	30671	11	31236	13	37932
4,5,6,8	3433	5	6441	2	30151	4	30259	5	30409	9	30672	11	31237	13	37934
1,5,6,9	3434	2	6541	2	30152	2,13	30260	5	30410	9	30673	11	31238	13	37936
7	3591	2	6542	2	30153	7	30271	5	30412	9	30674	4	31241	10	80503
7	3592	10	6771	2	30154	7	30272	5	30413	9	30675	11	31242		
10	3593	5	6831	3	30155	7	30273	9	30414	9	30676	11	31244		

The Model DCS-303 machine is the basic machine in compiling this catalogue, that is majority of parts used in the Model DCS-303 are used in all the Models of the DCS machines

Specialized parts for DCS-301, 305 and 321 are listed on page No. 10 and No. 11.

And, special purpose parts for DCS-303 equipped with Double

Row Tether Feed Dogs are listed on page No. 13

From the library of Superior Sewing Machine & Supply LLC

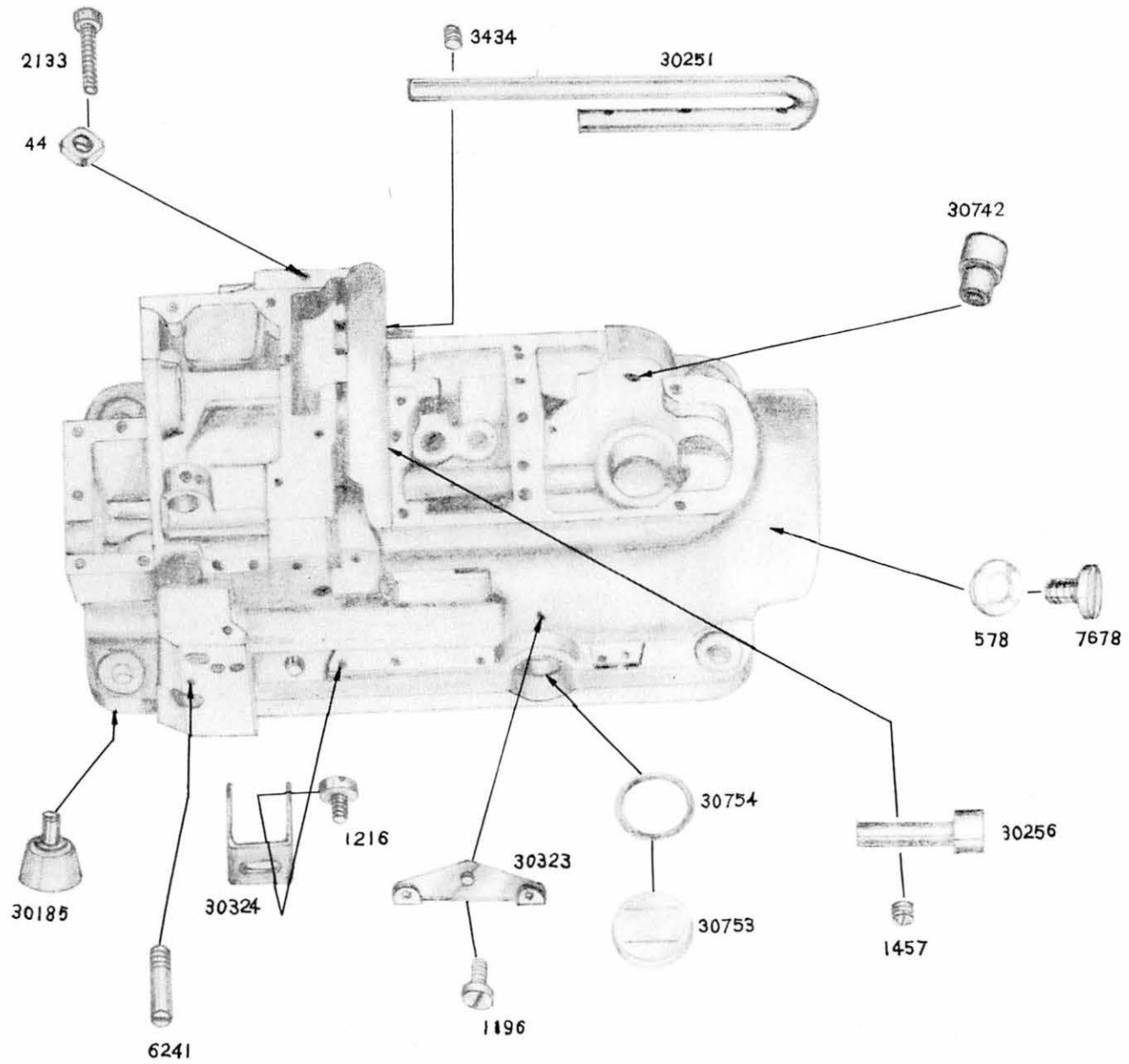

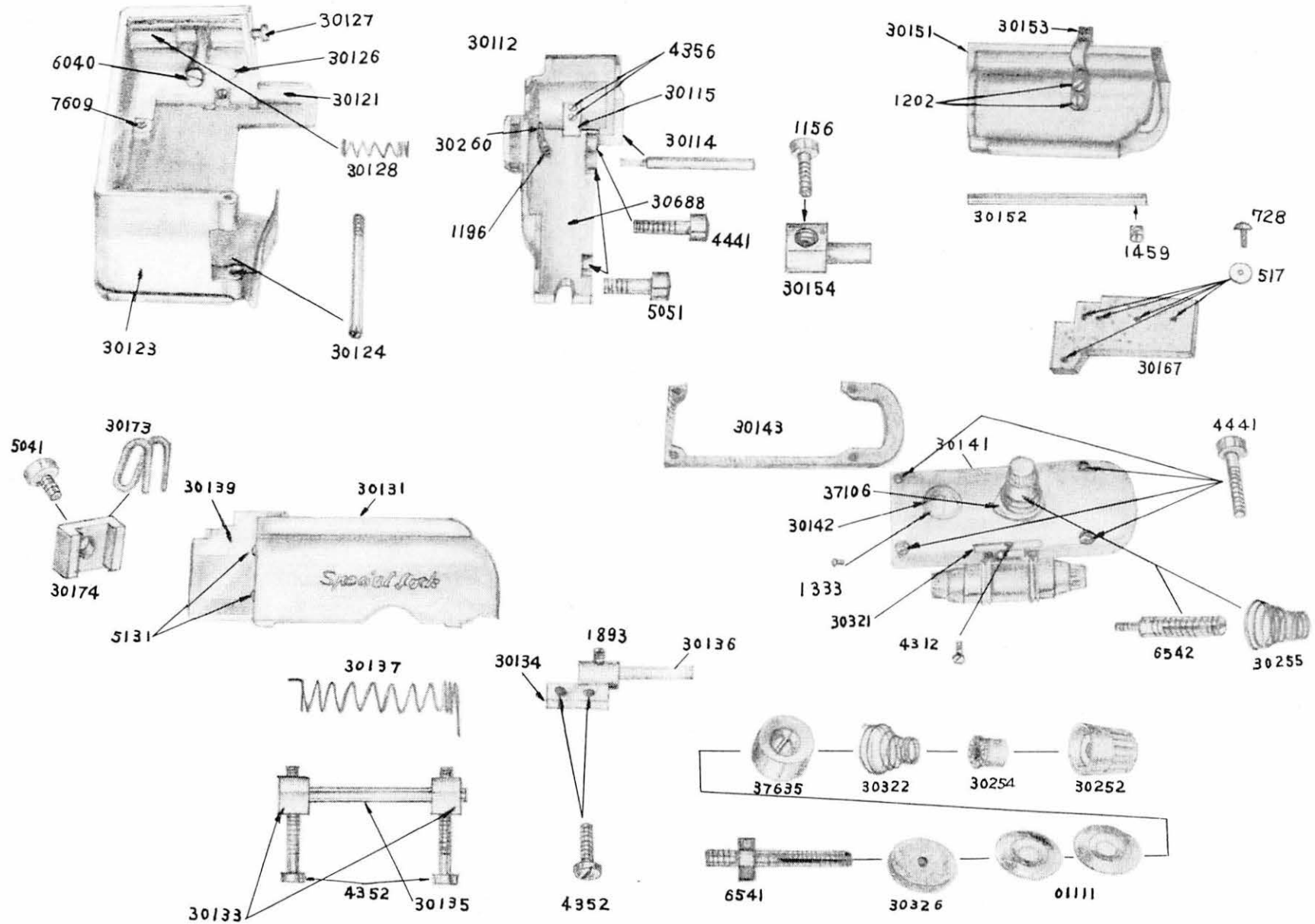

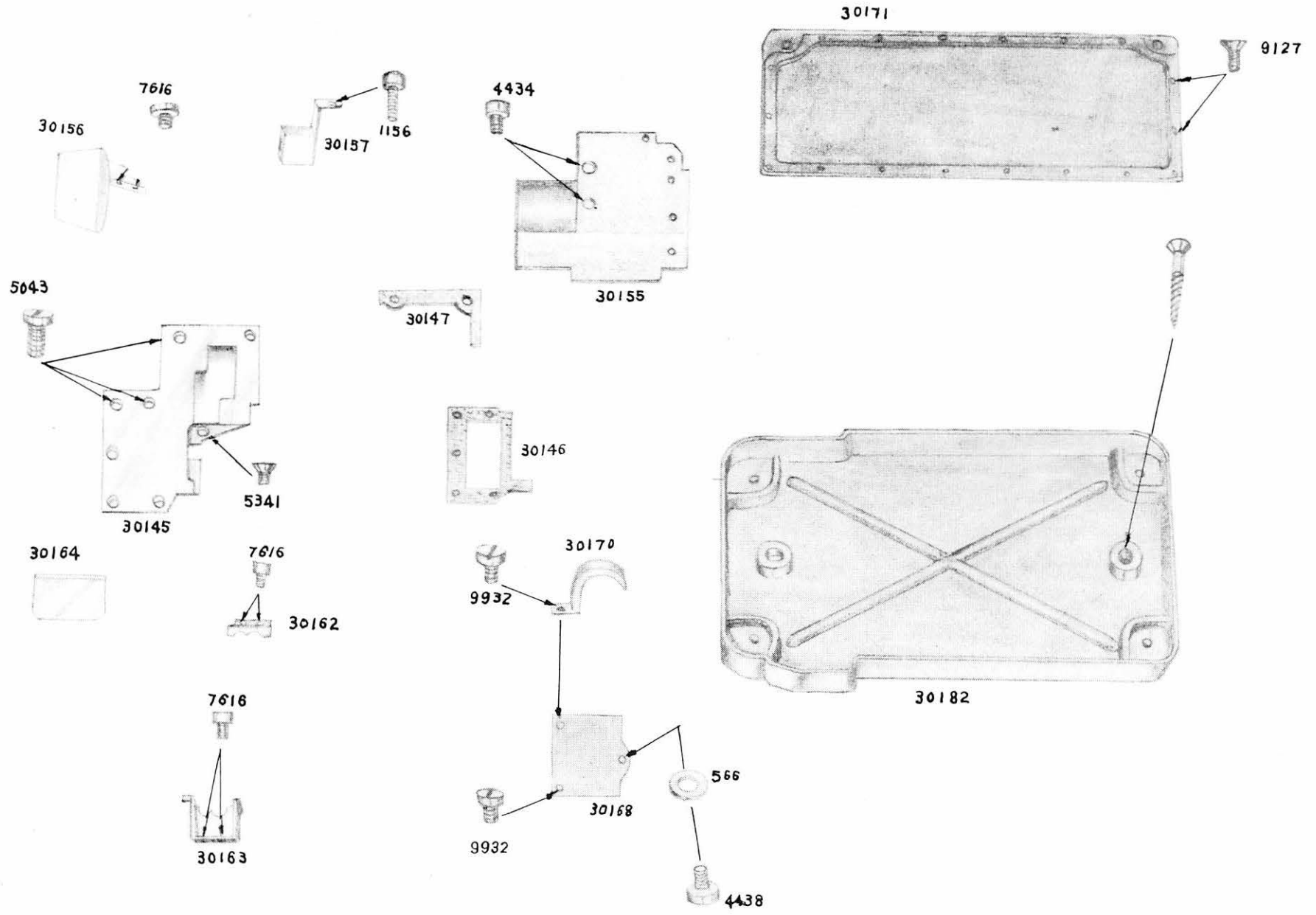

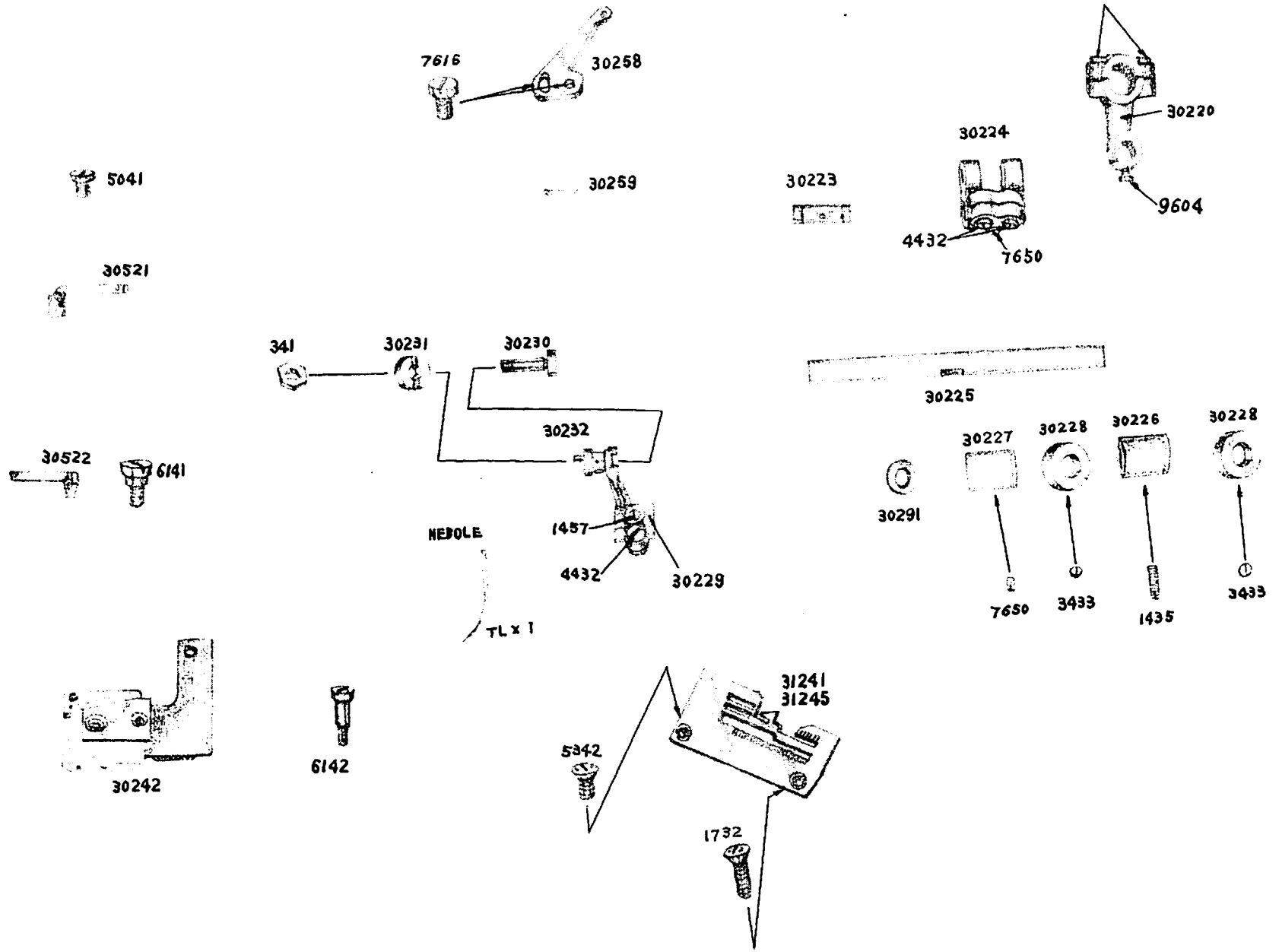

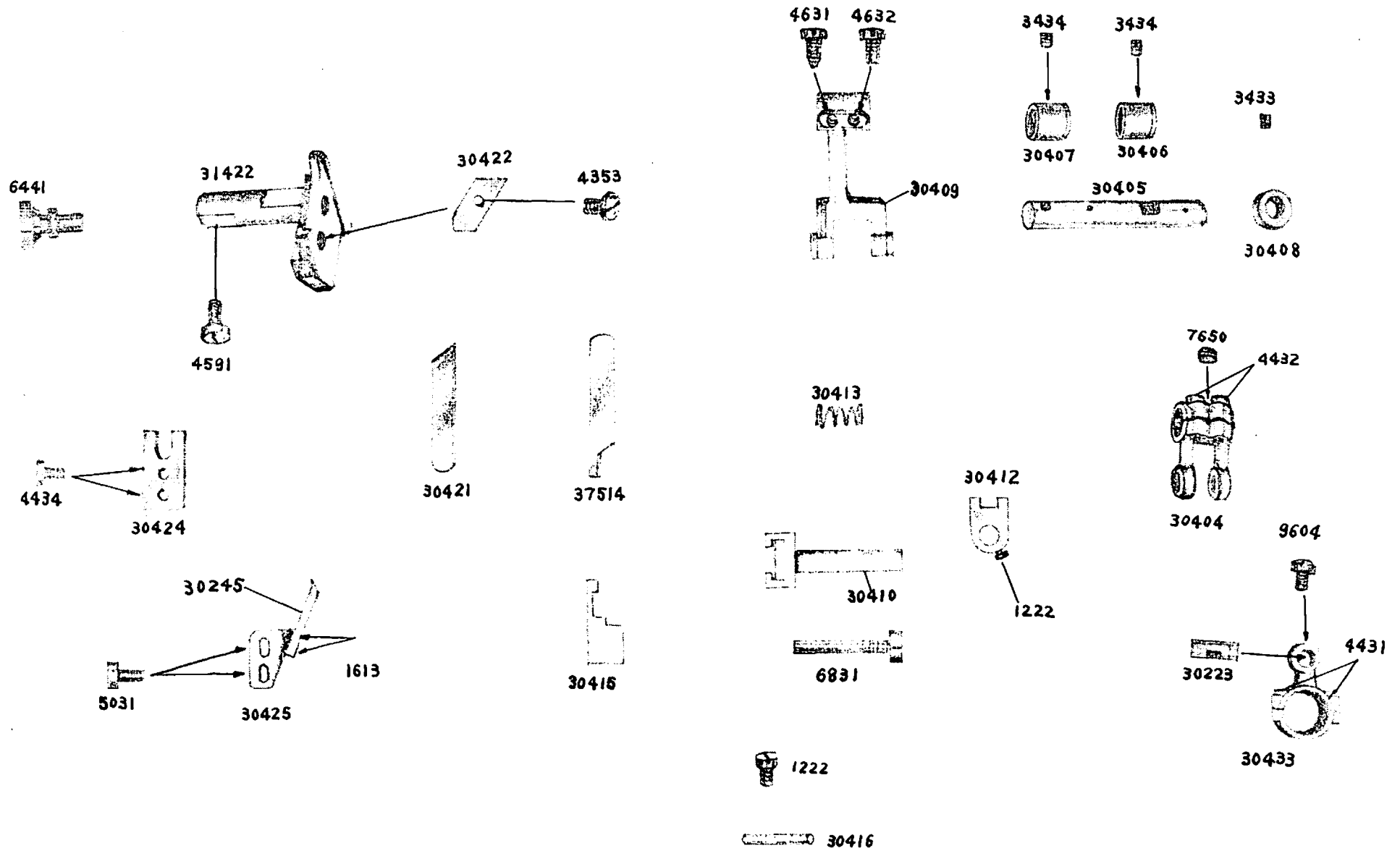

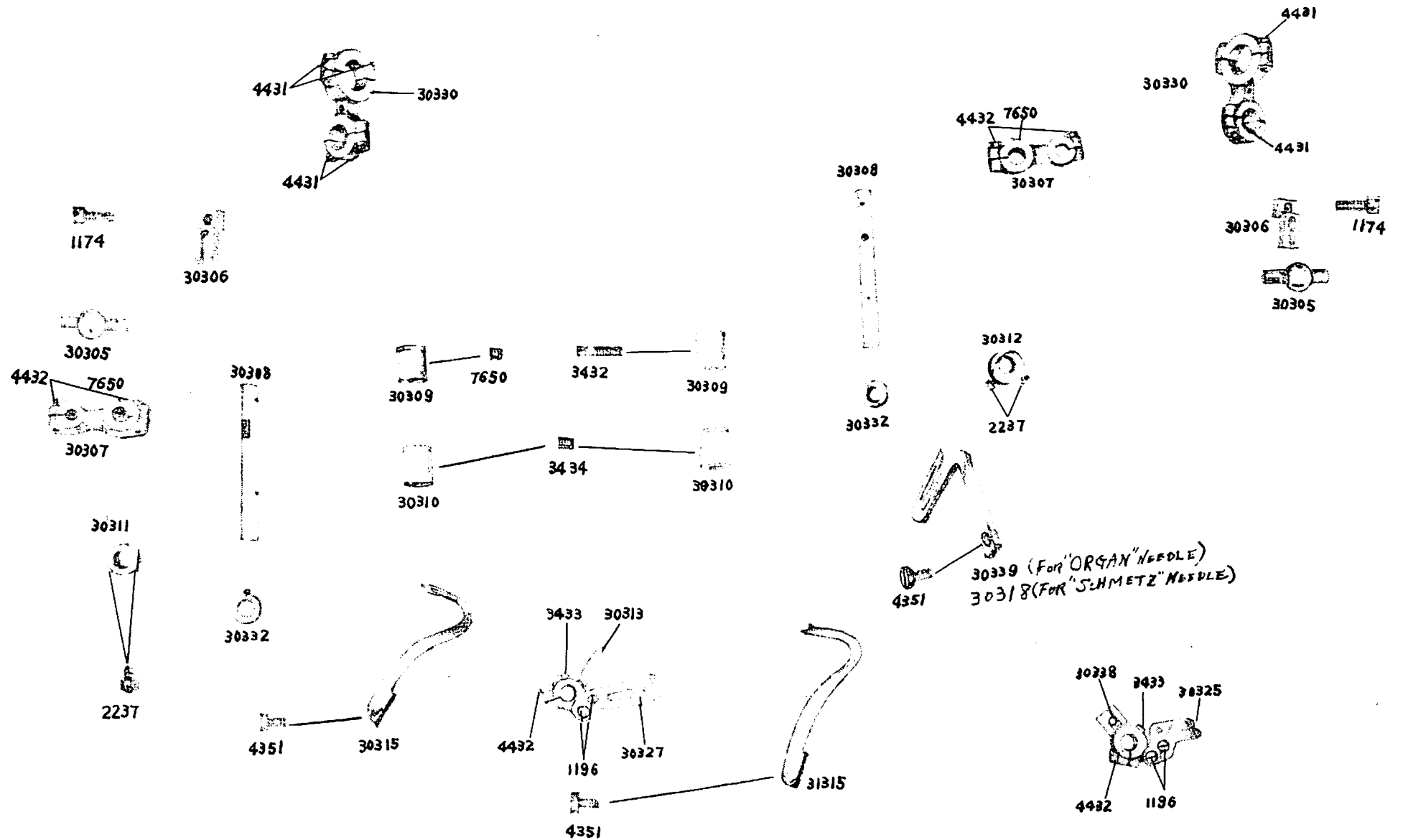

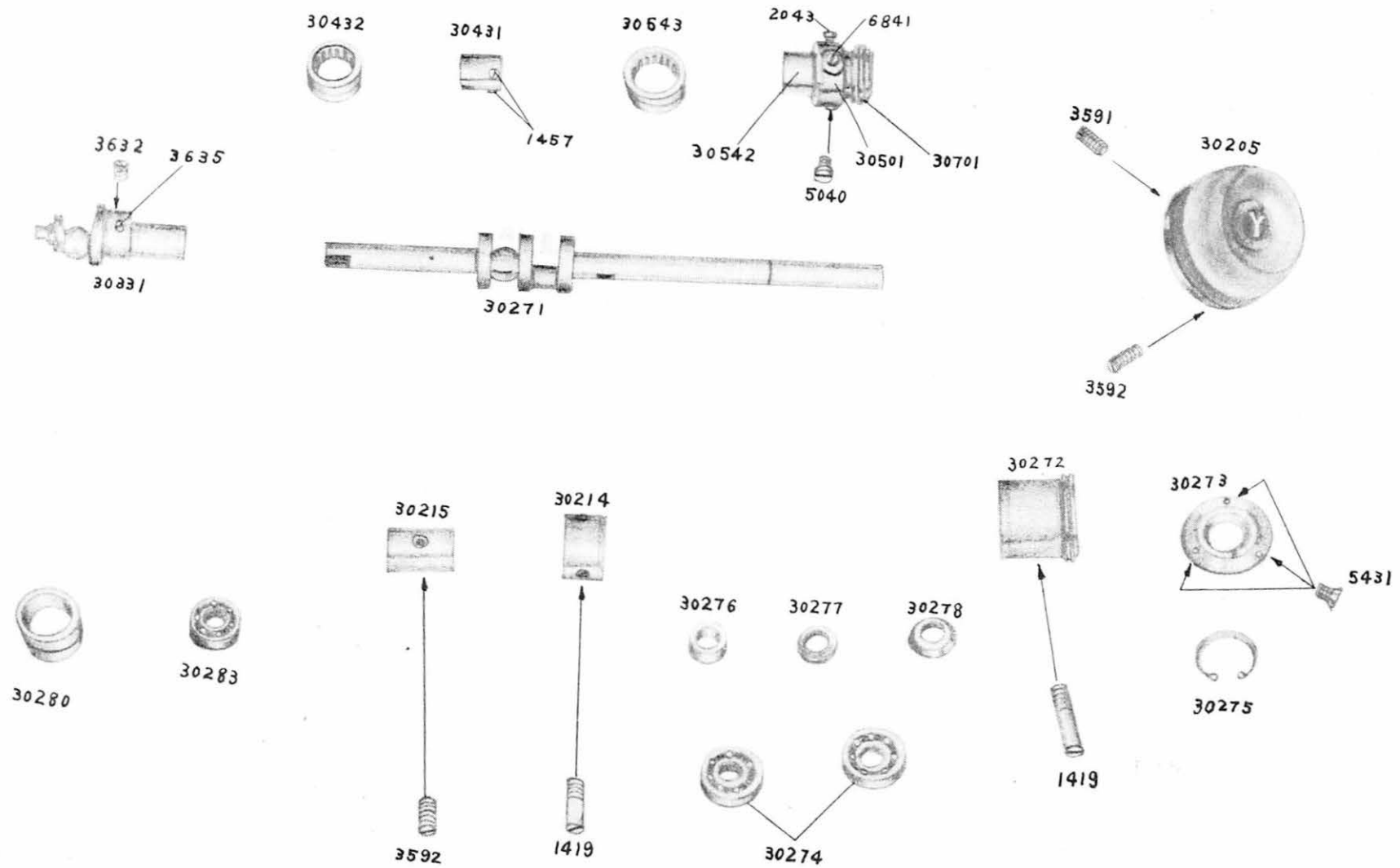

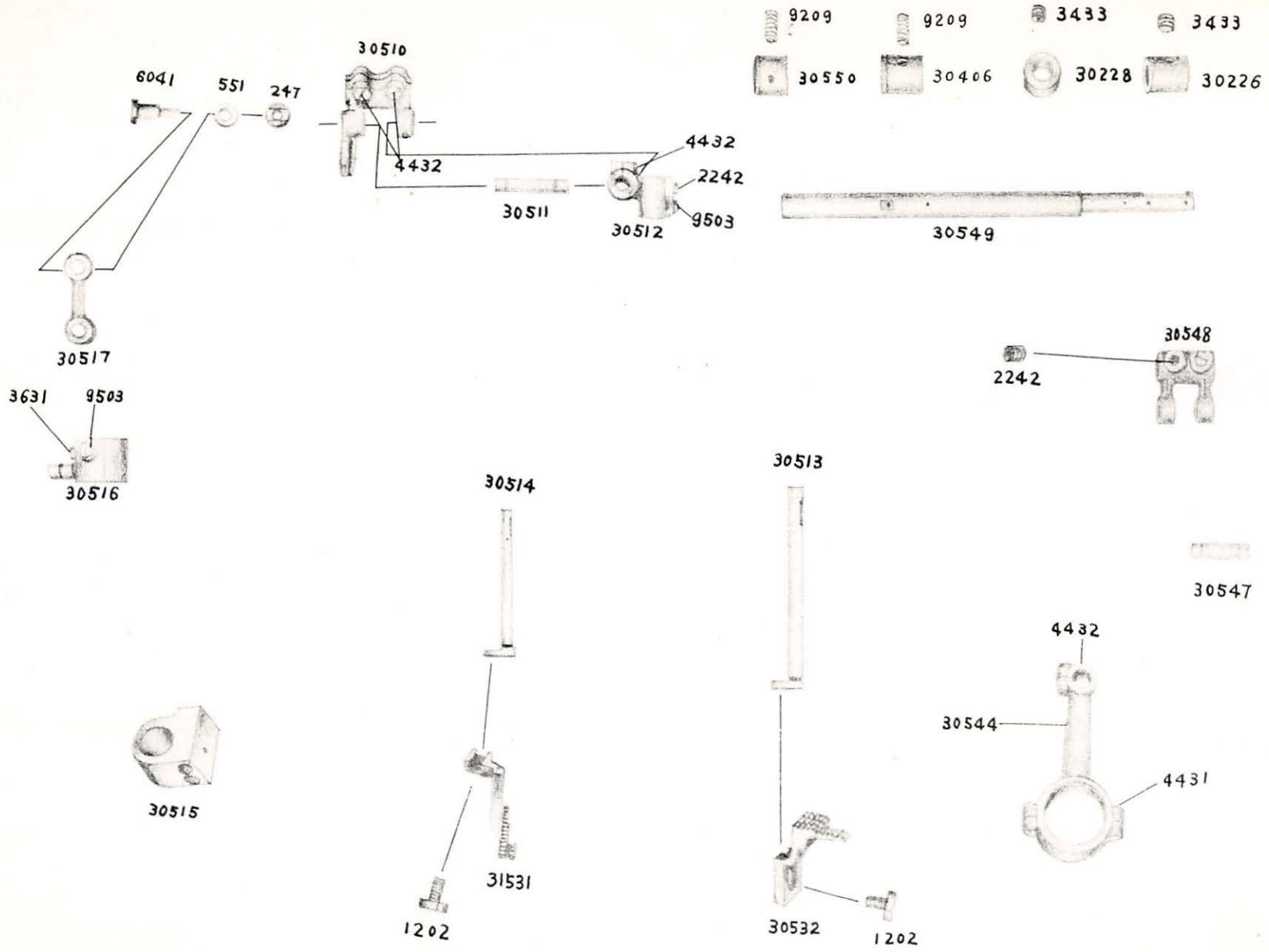

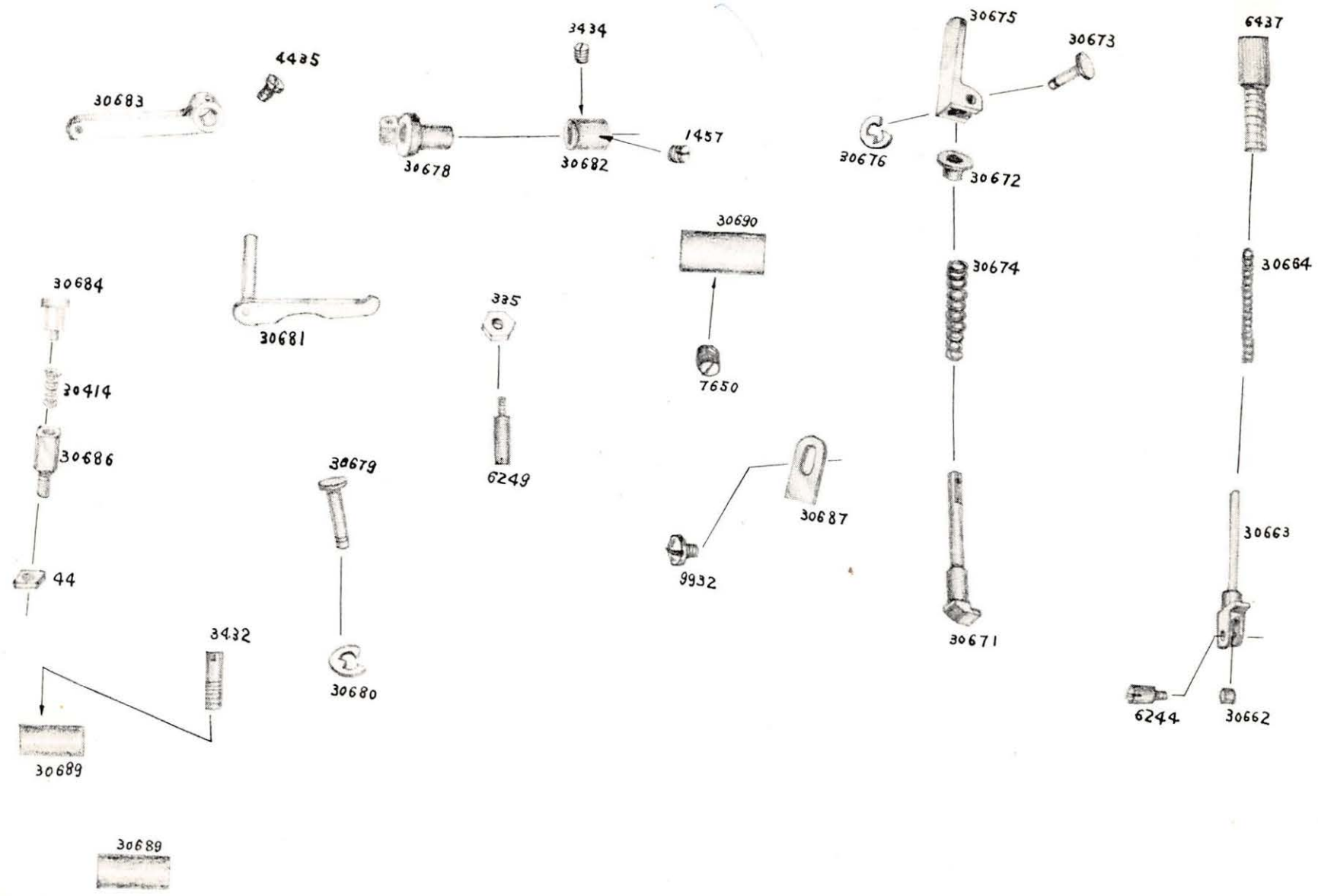

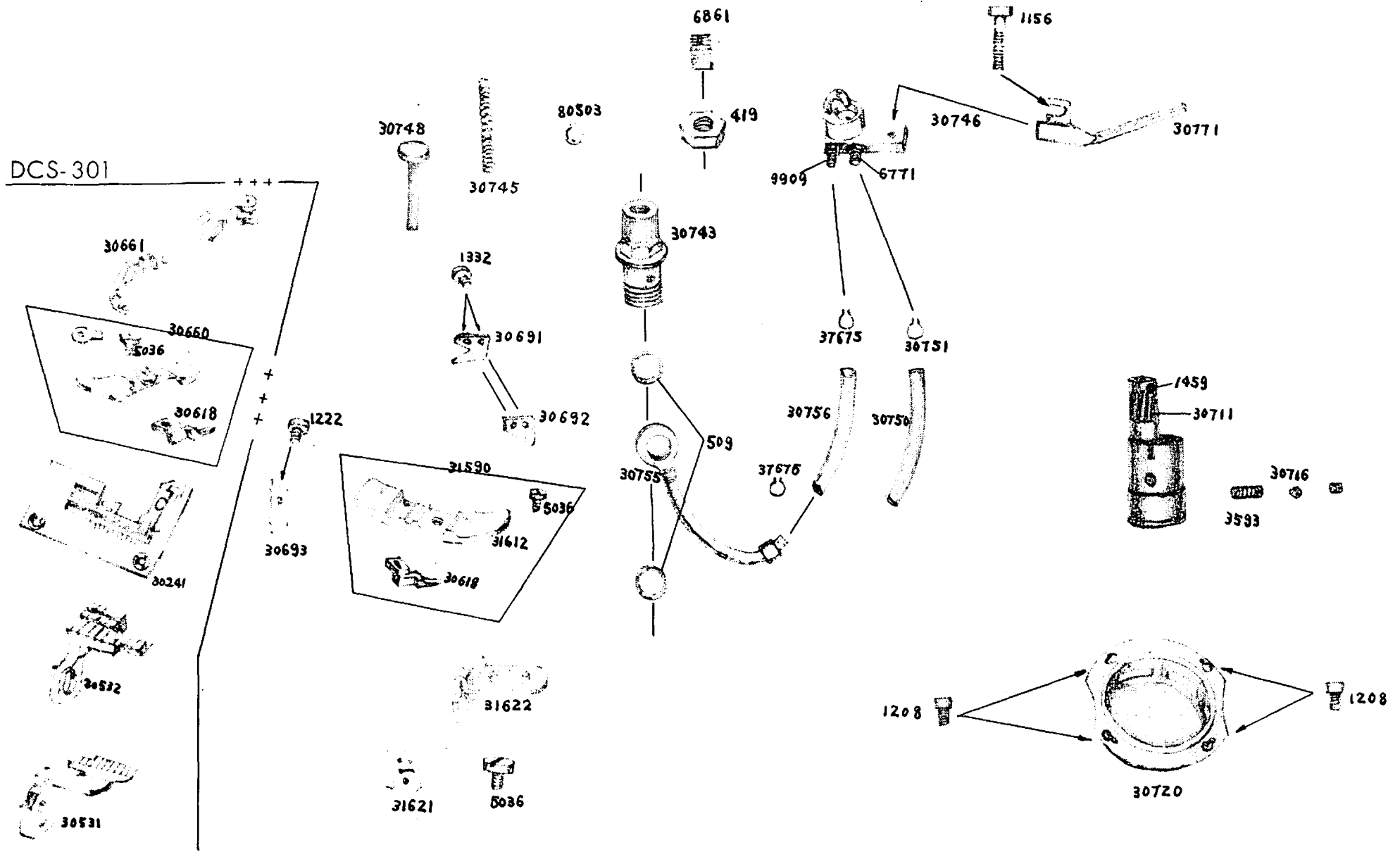

31533



31242



31231

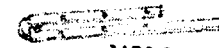

31236

31232



31238



+
+
+

31233



NEEDLE

TLx9

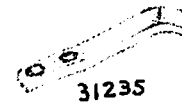
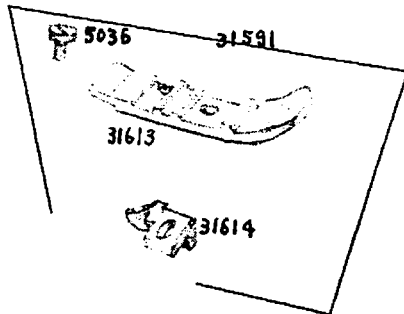

31235



31237

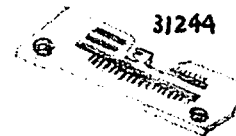

31244

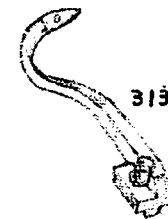

31317

(SPECIAL PURPOSE)
DOUBLE ROW TEETHED
FEED DOG

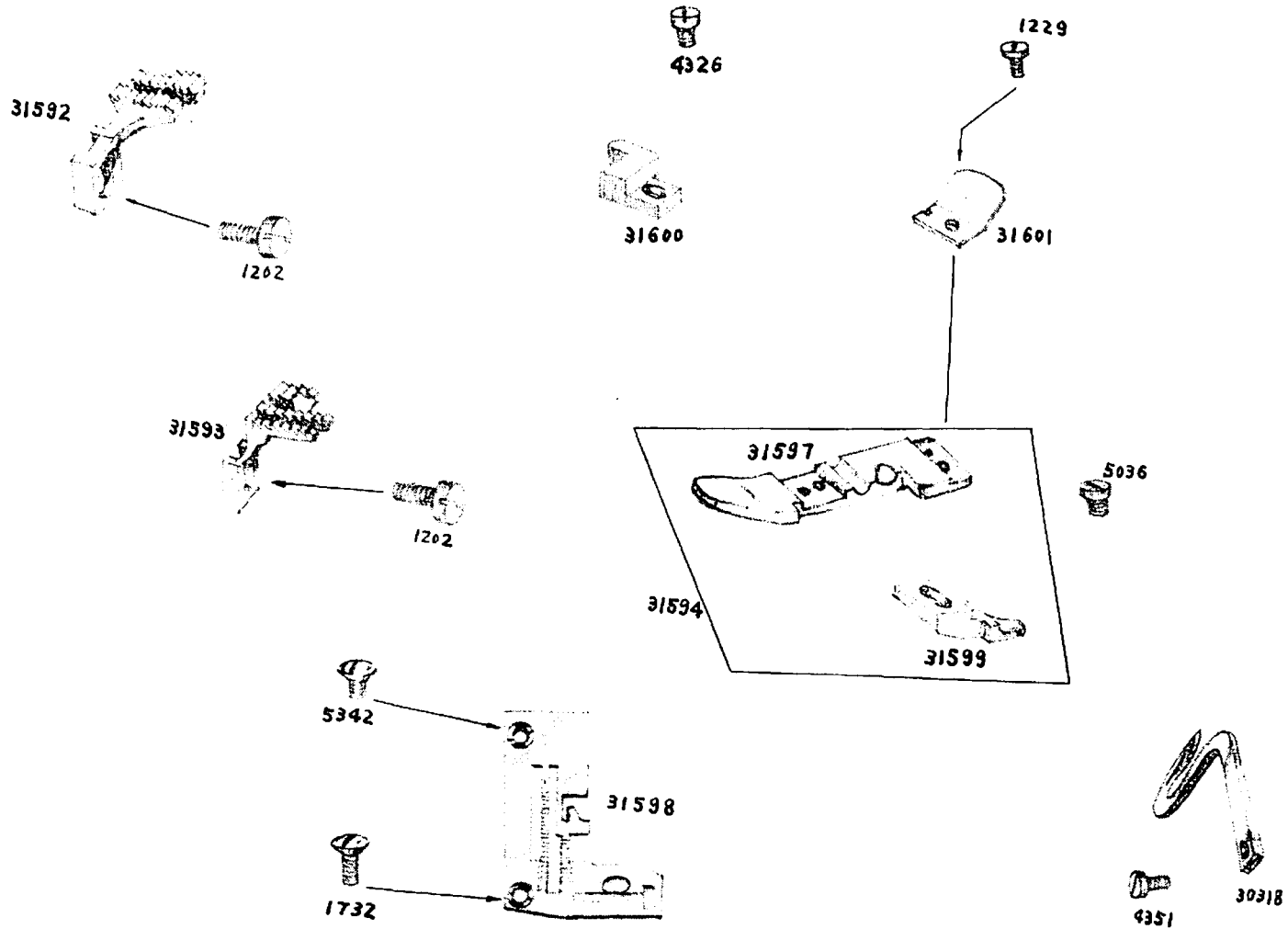

37911



37934

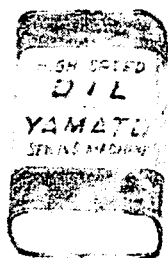

37932



37936

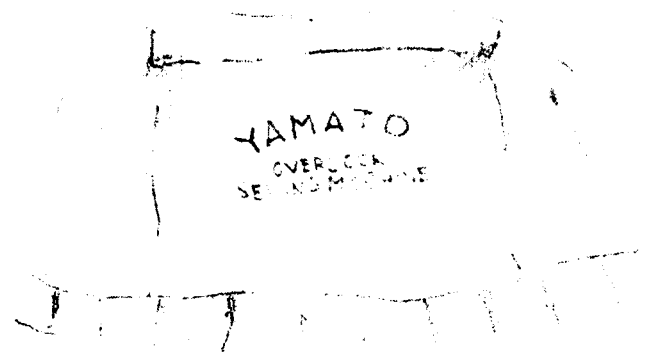

1398

6903



30260



30421



37514



37913

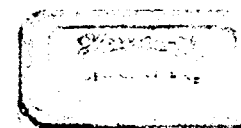

37918



37912

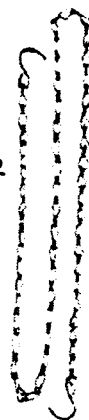

37917



37901



37902

37903

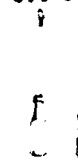

37909



NEEDLE
TL-1

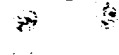

6904



6903



32550

